

1 2 3 4 5 6

A

A

B

B

C

C

D

D

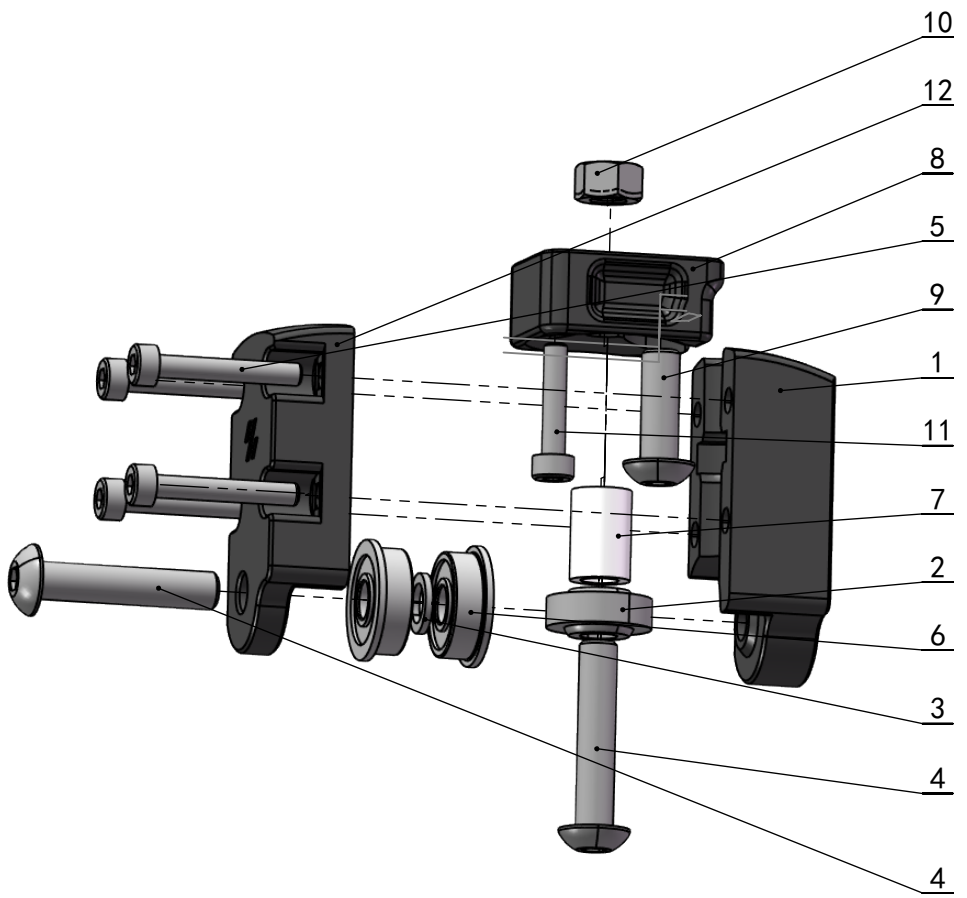

NO.	Part Name	QTY
1	Z_Bearing_Block_Bottom_With_Pulley_Right_B_x2	1
2	GE5C Spherical Bearing	1
3	M5_1x8mm_Shim	2
4	M5x25_BHCS (M5X27 Better)	2
5	M3x20 SHCS	4
6	C-EFL605ZZ	2
7	M5x12x8 NUT	1
8	Z_Bearing_Block_Top_X4	1
9	M5x15_BHCS	1
10	M5x4_Nut	1
11	M3x15_SHCS	1
12	Z_Bearing_Block_Bottom_With_Pulley_Right_A_x2	1

UNLESS OTHERWISE SPECIFIED: DIMENSIONS ARE IN MILLIMETERS SURFACE FINISH: TOLERANCES: LINEAR: ANGULAR:			FINISH:			DEBURR AND BREAK SHARP EDGES		DO NOT SCALE DRAWING		REVISION	
NAME	SIGNATURE	DATE				TITLE: Z_Bearing_Block_Bottom _With_Pulley					
DRAWN	ZZP8202					DWG NO. Z_Bearing_Block_Bottom _With_Pulley_01					
CHK'D											
APPV'D											
MFG											
Q.A					MATERIAL:	DWG NO.		A4			
					WEIGHT: 9.855	SCALE: 1:1		SHEET 1 OF 1			

1 2 3 4 5 6