

Lable by laser engraving.
SN # code by:
YYMMDD+4 series number

DIAGRAM

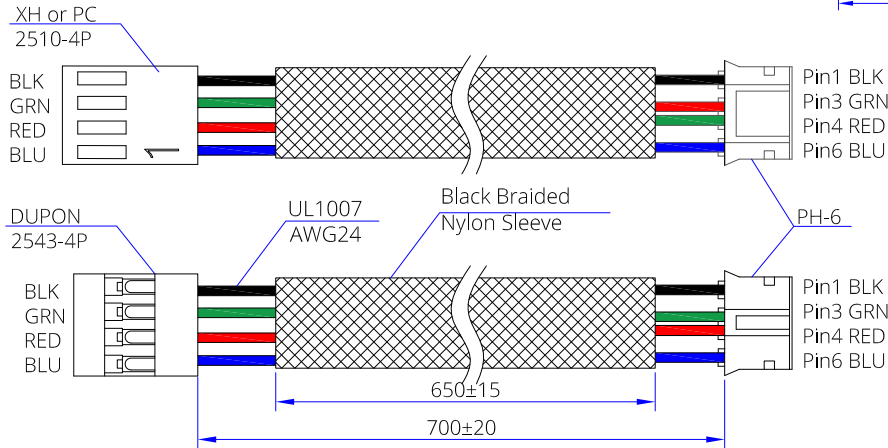

Gear Specification	
Module	m=0.5
Teeth Number	z=14
Pressure Angle	a=20°
Pitch Diameter	d=7
Outside Diameter	da=8
Material	Heat Treated Steel

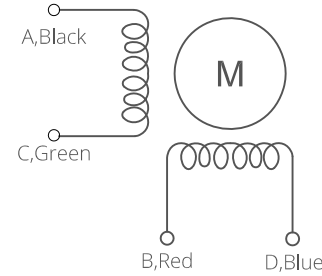
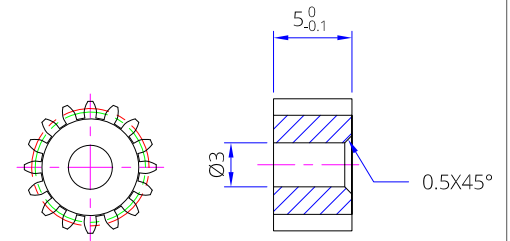

Items	Specification	Items	Specification
Phase Number	2	Step Angle	1.8° ± 5%
Rated Voltage	DC 5.5V / Phase	Rated Current	DC 1.0A / Phase
Phase Resistance	5.5x(1±10%) Ω	Phase Inductance	7x(1±20%) mH
Holding Torque	200mN-m MIN	Detent Torque	10 mN-m REF.
Rotation Direction	A-AB-B CW	Insulation Resistance	100Mohm(DC500V)
HI-POT	AC600V/1mA/1S	Insulation Class	Class B 130°C
Rotor Inertia	34 g-cm ²	Weight	0.15 Kg REF

B	---	Change laser engraving.	Xu SD	J.B.	11/21/20
A	---	NEW RELEASE	Xu SD	J.B.	3/25/20
REV.	ECN NO.	DESCRIPTION	MADE BY	APPR. BY	DATE
		VIEW			
		SCALE	NA		
		LDO Motors Co., Ltd.			
		Part NO. BONDTECH Extruder Motor LDO-42STH25-1004ACG(BDT)			
DRAWN BY	CHECKED BY	APPR. BY	DATE	FACTORY CODE	SHEET NO.
Xu SD	J.B.	J.B.	8/28/20		1/1